

# GAWLER CIVIC CENTRE

*...a venue like no other*





# Gawler



---

## Civic Centre Welcome

---

Café  
Council Chamber  
Business Innovation Hub  
Institute  
Town Hall  
Library  
Youth Space  
Cultural Heritage Centre  
Function Rooms

---

*The Gawler Civic Centre’s meeting and event spaces are a feature within the iconic and culturally significant State Heritage listed Institute and Town Hall buildings.*

*We can provide a tailored package for up to 250 guests in The Institute, with our preferred caterer Niina Marni Kadlitiya Café.*

***Our meeting and event spaces provide a central and stunning community space for bespoke community and corporate celebration, enjoyment and connection.***

*Only 55 minutes north of Adelaide, the Gawler Civic Centre provides four distinct event spaces and ten intimate meeting and break-out rooms. We can cater for up to 600 persons across the fully accessible Civic Centre site.*

*We look forward to your visit and for the opportunity to show you our magnificent spaces... a venue like no other!*

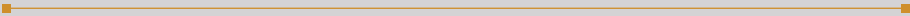

# CONTENTS

Venues for Hire ..... 5

*Institute Event Spaces* ..... 6

*Town Hall Meeting Rooms* ..... 8

*Room Capacities* ..... 9

Niina Marni Kadlitiya Café ..... 11

Parking..... 15

Contact..... 16



## VENUES FOR HIRE

---

*...entertaining, intimate and interactive performances and events*

**The Institute event spaces and Town Hall meeting rooms** are equipped with state of the art audio visual technology and Wi-Fi. They are versatile spaces that can be setup in a variety of formats.

*With direct access to an onsite caterer and other local business options, our team will work with you to meet your catering needs.*



## INSTITUTE EVENT SPACES

**The Institute** is suitable for all types of corporate, social and community functions, including conferences, expos, seminars, gala balls, wedding receptions, quiz nights, presentations, cabaret performances,

birthday parties and more. The Institute has a total capacity to seat 250 in an historic and stunning venue, exuding a sense of prestige and grandeur.

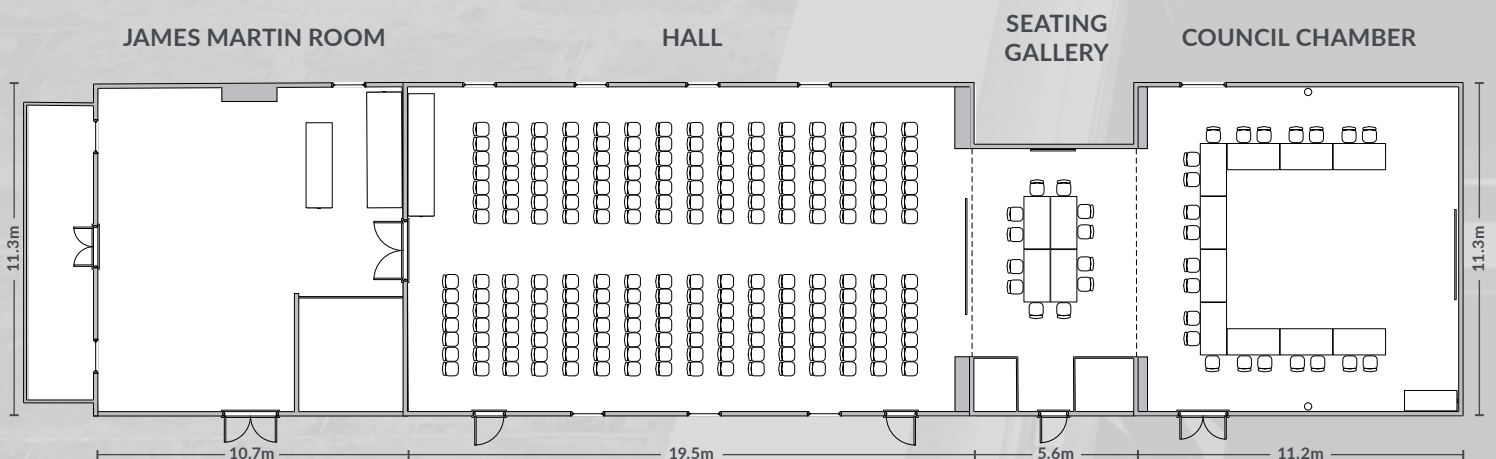

## HALL

The **Hall** is the premier event space within The Institute. It is architecturally significant with grand 7 metre high ceilings and beautiful heritage windows that provide extensive natural light.

The Hall can cater for function groups up to 210 and features an intelligent audio-visual system including a 7,000 lumens projector, 180" motorised screen and line array sound system.

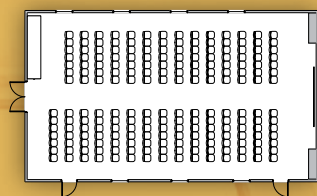

**THEATRE** 203 people

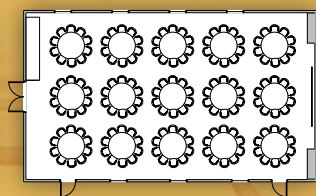

**BANQUET** 150 people

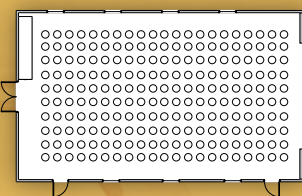

**COCKTAIL** 210 people

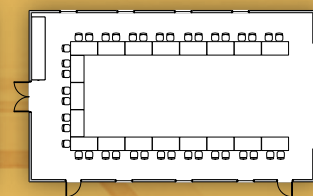

**U-SHAPE** 40 people

## COUNCIL CHAMBER

The **Council Chamber** is a versatile event and meeting space. 120 guests can be catered as a cocktail event, 112 theatre style or 90 in a banquet set-up.

Quality audio-visual equipment compliments this flexible space – 5,500 lumens projector, 140" motorised screen and a full conference audio system.

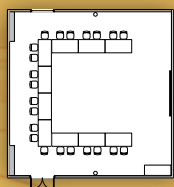

**U-SHAPE** 22 people

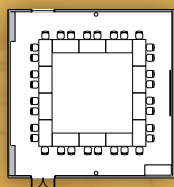

**BOARDROOM** 32 people

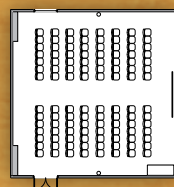

**THEATRE** 112 people

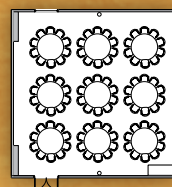

**BANQUET** 90 people

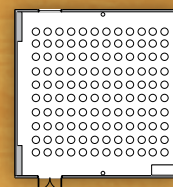

**COCKTAIL** 120 people

## JAMES MARTIN ROOM

The prestigious **James Martin Room** delivers a wow factor for any special occasion. Enter the James Martin Room via the magnificent staircase and celebrate your event on the balcony overlooking Murray Street.

Integrating nineteenth century heritage with modern, contemporary architecture, this light-filled room exudes grandeur. The James Martin Room can cater for up to 72 guests for a cocktail event or is a perfect pre-function space when using the conjoined Hall.

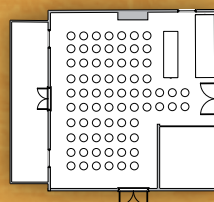

**COCKTAIL** 72 people

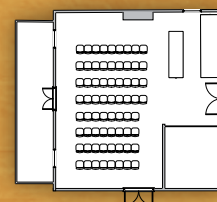

**THEATRE** 68 people

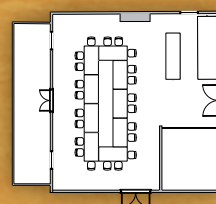

**BOARDROOM** 22 people

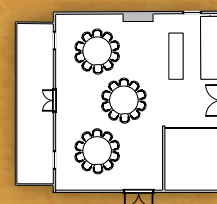

**BANQUET** 30 people

## SEATING GALLERY

The **Seating Gallery** is an intimate meeting space. Operable walls allow this area to open into both the Council Chamber and Hall spaces for larger events as required.

Separately, the Seating Gallery can cater for up to 35 guests and has a wall mounted 80" display screen.

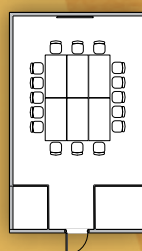

**BOARDROOM**  
16 people

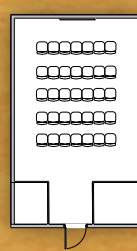

**THEATRE**  
35 people

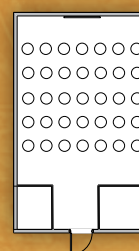

**COCKTAIL**  
35 people

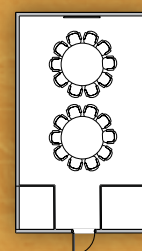

**BANQUET**  
20 people

## TOWN HALL MEETING ROOMS

The refurbished **Town Hall** provides a range of private meeting and workshop spaces. These rooms suit community and corporate

meetings, workshops, staff training, interviews and counselling. They can also be a perfect temporary office space.



## ROOM CAPACITIES

The Institute boasts four beautiful **event spaces** that can be configured in a variety of formats, with a total capacity of 250.

Ten intimate **meeting rooms** are available in the **Town Hall** that can be configured in a variety of formats – individual capacity of 4 through to 14.

| Institute Event Spaces                             | Floor       | Theatre | Banquet 10/table | Cabaret 8/table | Cocktail | Boardroom | U-Shape | Capacity |
|--|-------------|---------|------------------|-----------------|----------|-----------|---------|----------|
| Seating Gallery                                    | First Floor | 35      | 20               | 16              | 35       | 16        | 12      | 35       |
| James Martin Room                                  |             | 68      | 30               | 24              | 72       | 22        | 16      | 72       |
| Council Chamber                                    |             | 112     | 90               | 72              | 120      | 32        | 22      | 120      |
| Hall   |             | 203     | 150              | 120             | 210      |           | 40      | 210      |
| • Council Chamber<br>• Seating Gallery             |             | 147     | 110              | 88              | 155      | 48        |         | 155      |
| • Hall<br>• Seating Gallery                        |             | 238     | 170              | 136             | 245      |           |         | 245      |
| • Hall<br>• James Martin Room                      |             | 250*    | 180              | 144             | 250*     |           |         | 250*     |
| • Hall<br>• James Martin Room<br>• Seating Gallery |             | 250*    | 200              | 160             | 250*     |           |         | 250*     |
| • Hall<br>• Council Chambers<br>• Seating Gallery  |             | 250*    | 250*             | 208             | 250*     |           |         | 250*     |
| • Full Institute                                   |             | 250*    | 250*             | 232             | 250*     |           |         | 250*     |

*\*Total capacity 250 people reached*

| Town Hall Meeting Rooms     | Floor        | Boardroom | U-Shape | Capacity |
|-----------------------------|--------------|-----------|---------|----------|
| Town Hall Meeting Room LG.1 | Lower Ground | 4         |         | 4        |
| Town Hall Meeting Room LG.2 | Lower Ground | 4         |         | 4        |
| Town Hall Meeting Room G.1  | Ground Floor | 4         |         | 4        |
| Town Hall Meeting Room 1.2  | First Floor  | 4         |         | 4        |
| Town Hall Meeting Room LG.3 | Lower Ground | 6         |         | 6        |
| Town Hall Meeting Room LG.4 | Lower Ground | 6         |         | 6        |
| Town Hall Meeting Room G.2  | Ground Floor | 6         |         | 6        |
| Town Hall Meeting Room 1.1  | First Floor  | 10        |         | 10       |
| Town Hall Meeting Room 1.3  | First Floor  | 10        |         | 10       |
| Town Hall Meeting Room G.3  | Ground Floor | 14        | 12      | 14       |



THEATRE



BANQUET



CABARET



COCKTAIL

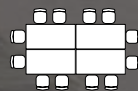

BOARDROOM



U-SHAPE



# PARKING

The map below highlights a variety of all day and timed public parking locations that are within a short 5-10 minute walk of the Gawler Civic Centre. Public transport is also available within easy walking distance.





Gawler Civic Centre  
89-91 Murray Street, Gawler

**Venue Hire enquiries and bookings:**

Phone: 8522 9267

[civiccentre@gawler.sa.gov.au](mailto:civiccentre@gawler.sa.gov.au)

[www.gawler.sa.gov.au/gawlerciviccentre](http://www.gawler.sa.gov.au/gawlerciviccentre)

