

MIN COVER TO TOP OF SECTION TO BE 75MM. WHERE LESS THAN 75MM SECTION TO EXTEND TO SURFACE OF FOOTPATH WITH CHEQUER PLATE FINISH.

5mm HOTDIP GALVANIZED SECTION WELDED TO BASE PLATE. SECTION TO SIT UPON COMPACTED MATERIAL

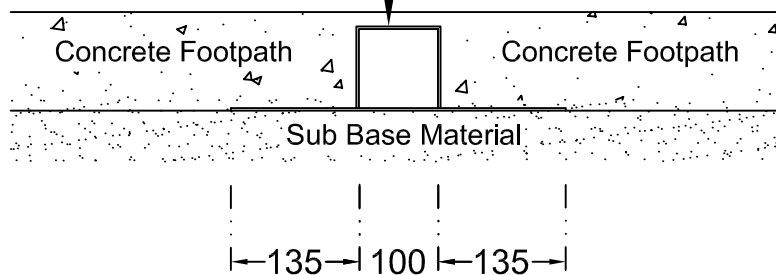

SECTION A-A

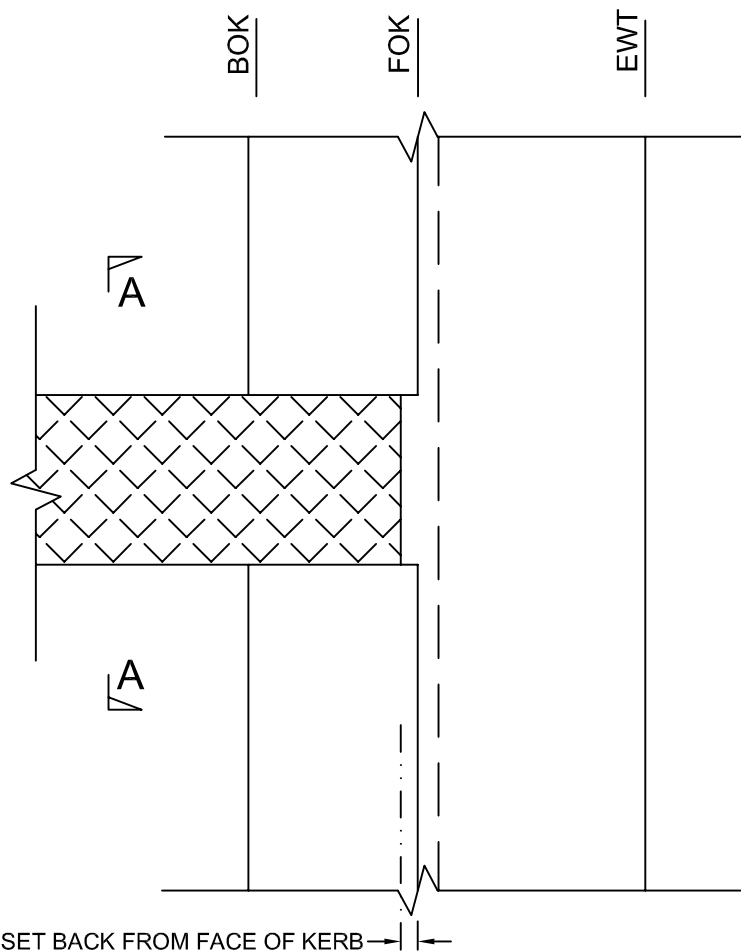

150mm BARRIER KERB CHEQUER PLATE DRAIN

Note: THE DRAINAGE CONNECTOR IS NOT TO BE LOCATED CLOSER THAN 3 METRES TO THE UPSTREAM SIDE OF A SIDE ENTRY PIT AND 1METRE FROM DRIVEWAY CROSSOVER.

DRAWN	N. LANGLEY S. HYDE	TOWN OF GAWLER	SCALE N.T.S.
CHECKED	D. COLLINS	STANDARD DETAILS	DRAWING NUMBER
DATE	JUNE 2011	BARRIER KERB DRAIN DETAIL	SK - 306 REV A